

# Sink KE - R15 Vintage Gun Metal

Kitchen Sinks

Code: 2156 086

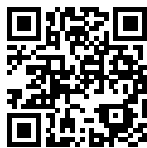

## DETAILS

|                        |   |
|------------------------|---|
| Coloring               | Gun Metal   |
| Edge/Installation Type | Flush-mount   Top-mount   |
| Finish                 | PVD   |
| Material               | AISI 304 stainless steel  |
| Texture                | Vintage   |
| Base                   | 45 cm   |
| Dimensions             | 440x440 mm  |
| Standard fittings      | Fixing hooks, gasket, drain, overflow and siphon, boxed packing |
| Mixer holes            | No standard holes   |

|               |   |
|---------------|---|
| Built-in hole | <a href="#">View technical data sheet</a> |
|---------------|---|

|         |    |
|---------|----|
| Drainer | No |
|---------|----|

|       |       |
|-------|-------|
| Width | 44 cm |
|-------|-------|

|                |              |
|----------------|--------------|
| Bowl dimension | 400 x 400 mm |
|----------------|--------------|

|                 |        |
|-----------------|--------|
| Number of bowls | 1 bowl |
|-----------------|--------|

|               |            |
|---------------|------------|
| Waste fitting | 3,5" drain |
|---------------|------------|

## FEATURES

|                           |  |
|---------------------------|--|
| Basket 3,5" waste fitting | The drain is equipped with a large 3.5" drain, with the practical basket cap that prevents the discharge of solid parts. |
|---------------------------|--|

|           |  |
|-----------|--|
| Gun Metal | The Gun Metal finish is obtained by treating steel with a physical process called PVD (Physical Vacuum Deposition) which deposits particles of noble metals on the surface. The result is a unique and refined aesthetic effect, and an improvement of the mechanical properties of the steel which is more resistant to impact and scratches. |
|-----------|--|

|                |   |
|----------------|---|
| High thickness | 1mm thick steel. A significant thickness, which guarantees the maximum sturdiness and durability. |
|----------------|---|

|                     |   |
|---------------------|---|
| Perimetral overflow | The overflow is always a security on the Foster sinks that prevents the overflow of water in case of oversights. The perimeter drain solution improves aesthetics thanks to its square and essential shape. |
|---------------------|---|

|              |  |
|--------------|--|
| Small radius | Bowls with squared shapes with a modern design and an increased capacity, for a minimal aesthetics connected with an extreme practicality. |
|--------------|--|

|             |   |
|-------------|---|
| VINTAGE PVD | The prestigious PVD finish combines with the care for detail of the Vintage finish, to create a combination of unique elegance. |
|-------------|---|

## TECHNICAL DATA

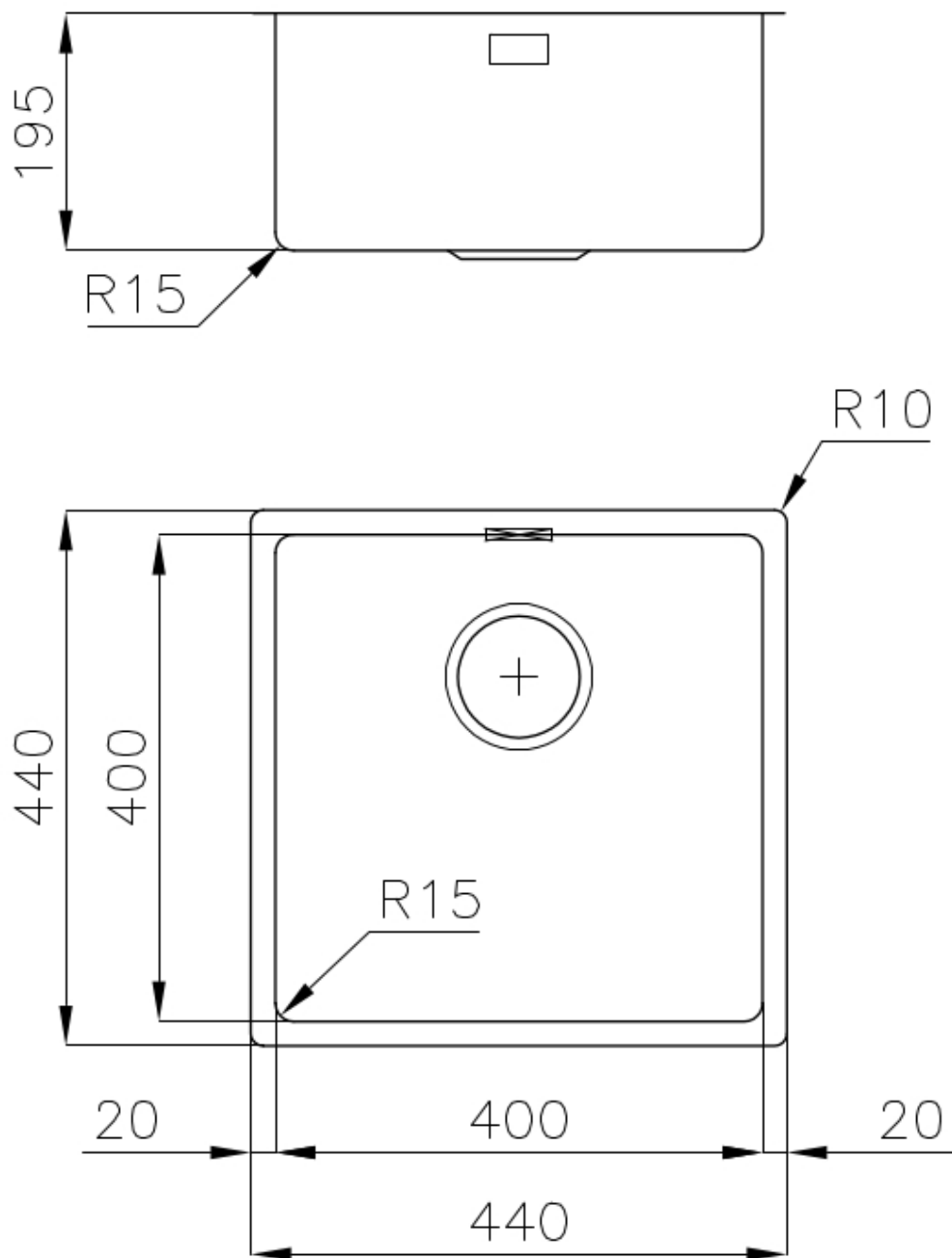

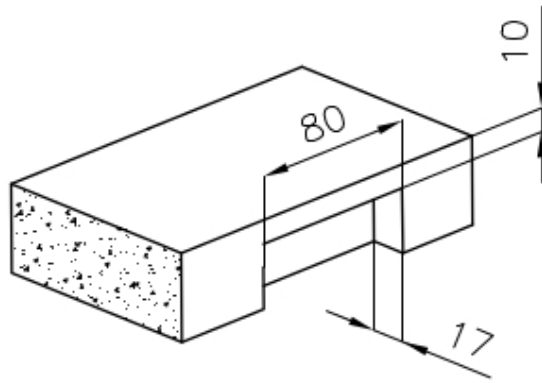

Intaglio per il troppo-pieno  
Recess for housing the over-flow

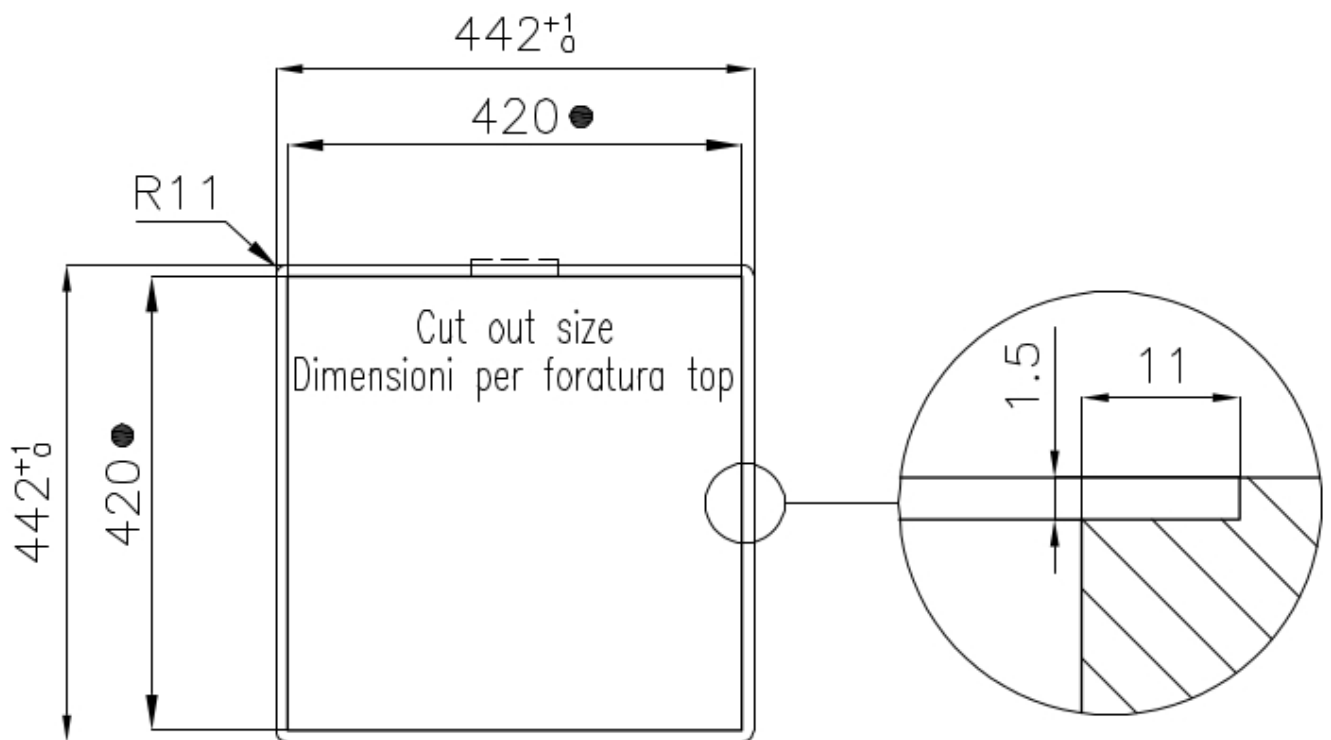

- Built-in cut out for FTS – Foratura per installazione FTS

## GALLERY



## OPTIONAL ACCESSORIES



**Cestello inox**  
8612 000



**Glass chopping board**  
8631 300



**HDPE Chopping board**  
8657 001



**HPDE Twin chopping board**  
8644 101

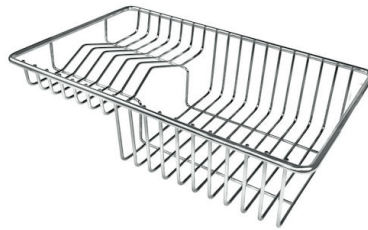

**Stainless steel plate rack**  
8100 303  
\* only in combination with the accessory  
8644 101



**Stainless steel plate rack**  
8100 201



**Stainless steel plate rack only  
usable in combination with the  
accessories 8644 003**  
8100 154



**White bowl**  
8153 100



**Graters kit with ring-holder and  
food collection tray**  
8159 101  
\* only in combination with the accessory  
8644 101



## **Stainless steel perforated tray**

8151 000

\* only in combination with the accessory  
8644 101

## **RECOMMENDED PAIRINGS**



### **Mixer Tap Bert**

8428 100



### **Mixer Tap KE**

8492 000

## **OPTIONAL AUTOMATIC WASTE FITTINGS**



### **Gun Metal automatic waste fitting - PG**

8407 110